

Detent hinges

screw-covers, technopolymer

MATERIAL

Acetal resin based (POM) technopolymer, black colour, matte finish.

ROTATING PIN

Acetal based (POM) technopolymer, black colour.

SCREW-COVERS

Polyester based (PBT) technopolymer, black colour, matte finish, snap-in assembly.

STANDARD EXECUTIONS

- **CFP-SH**: pass-through holes for countersunk head screws.
- **CFP-CH**: pass-through holes for cylindrical head screws.
- **CFP-EH**: pass-through holes for hexagonal head screws.

ROTATION ANGLE (APPROXIMATE VALUE)

- Max 195° (-15° and +180° being 0° the condition where the interconnected surfaces are on the same plane).
- Do not exceed the rotation angle limit so as not to prejudice the hinge mechanical performance.
- This hinge can be used combined with the hinge type CFQ, with the same design, without detent position.
- The detent device (ELESA patent) allows four different detent positions of the door (0°; +80°; +120°; +170°).
- To choose the convenient type and the right number of hinges for your application, see the Guidelines (on page).

RESISTANT TORQUE

All detent positions guarantee a resistant torque of about 1.1 Nm (which is the torque that must be applied to free the detent device of the hinge).

The hinge had been tested with more than 10.000 opening and closing cycles and the value of the resistant torque was unchanged.

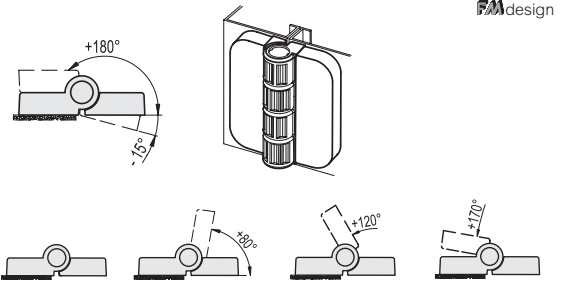

AXIAL STRESS		RADIAL STRESS		80° AND 90° ANGLED STRESS		120° ANGLED STRESS		170° ANGLED STRESS		Resistant torque
Maximum working load	Load at breakage	Maximum working load	Load at breakage	Maximum working load	Load at breakage	Maximum working load	Load at breakage	Maximum working load	Load at breakage	[Nm]
Ea [N]	Ra [N]	Er [N]	Rr [N]	E80 e E90 [N]	R80 e R90 [N]	E120 [N]	R120 [N]	E170 [N]	R170 [N]	1.1
300	1220	350	1970	345	620	285	855	400	1410	

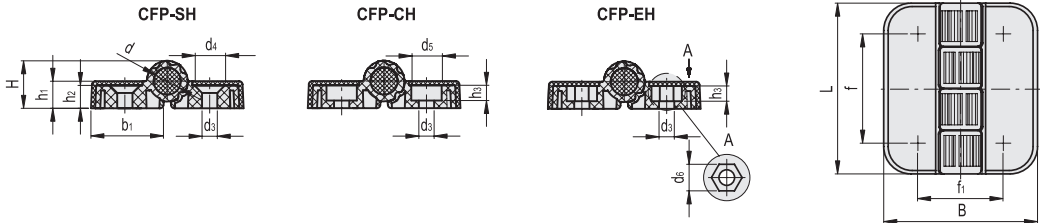

Code	Description	L	B	f	f1	H	h1	h2	h3	b1	d	d3	d4	d5	d6	C#	[Nm]	
426311-C9	CFP.50 SH-4-C9	50	45	32	25	14	8	7	-	21.5	8	4.5	8.5	-	-	1.5	17	
426312-C9	CFP.50 CH-4-C9	50	45	32	25	14	8	7	4.5	21.5	8	4.5	-	8.5	-	1.5	17	
426313-C9	CFP.50 EH-4-C9	50	45	32	25	14	8	7	4.5	21.5	8	4.5	-	-	7	1.5	17	

Suggested tightening torque for assembly screws.